

Diabetes Prevention Program (DPP) Testing Event Setup

Use the example below as a guide to set up your next DPP testing event. Not all setups will fall neatly into this format. Adjust as needed to fit your event space. A key goal is to offer as much privacy as possible between the testing and counseling stations. Ideally, try to set up the counseling station in a separate room.

Stations

Registration

Participants start here and fill out two forms:

1. Registration form
2. HIPAA consent form

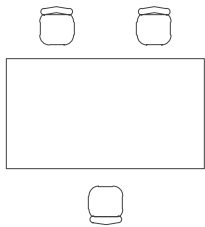

Waiting area(s)

Participants wait here:

1. Between stations 1 and 3
2. Between stations 3 and 4

You can set up one or two waiting areas (see examples below).

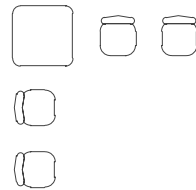

Testing stations

Clinicians perform fasting blood glucose tests. Stations should be private for comfort, but no health information will be discussed or visible.

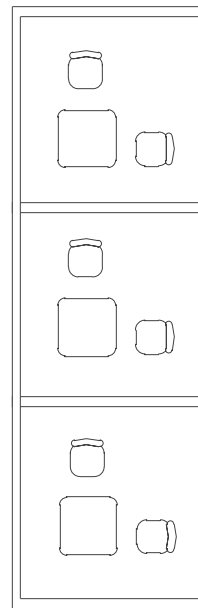

Counseling stations

Coaches explain results and (if applicable) invite participants to onsite classes. **Stations must be private.** Rooms with doors are recommended.

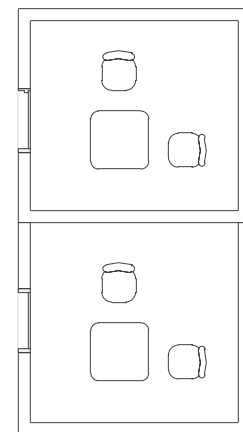

(Number of stations varies based on the number of participants.)

Setup examples

